

DESIGN THEME:
"THE RIPPLE EFFECT"
Making an impact in the local
community and across the country

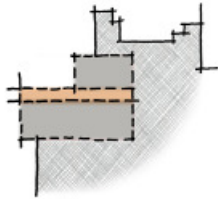

INITIAL FOOTPRINT ALLOTMENT

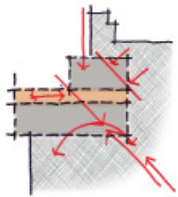

DESIGN PROCESS

DESIGN FACTORS:
- Views from main access road to main entry
- Drop-off drive
- Connection to residential and commercial

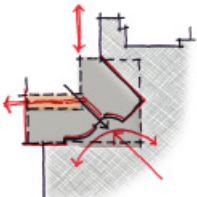

FINAL FOOTPRINT

SITE PLAN

