

Project

- Case 1
  - Localization/Climate: CINCINNATI MUNICIPAL AP LUNKI OH
  - Building
    - PH case: Passive house: Residential
      - Zone 1: South Tower
        - Visualized components
          - Component 1: South Tower Slab
          - Component 2: South Tower Walls
          - Component 3: South Tower Roof
          - Component 4: South Tower Windows
          - Component 5: South Tower Windows
          - Component 6: South Tower Windows
          - Component 7: South Tower Windows
          - Component 8: South Tower Windows
          - Component 9: South Tower Windows
          - Component 10: South Tower Windows
          - Component 11: South Tower Windows
          - Component 12: South Tower Windows
          - Component 13: South Tower Windows

General Report data & results

Scope **Passive House verification** View **Normal**

### BUILDING INFORMATION

Category: **Residential**  
 Status: **In planning**  
 Building type: **New construction**  
 Year of construction:  
 Units: **40**  
 Number of occupants: **78.6 (Verification)**

### Boundary conditions

Climate: **OH**  
 Internal heat gains: **0.7 Btu/hr ft<sup>2</sup>**  
 Interior temperature: **68 °F**  
 Overheat temperature: **77 °F**

### Building geometry

Enclosed volume: **405220.2 ft<sup>3</sup>**  
 Total area envelope: **55807.6 ft<sup>2</sup>**  
 AV ratio: **0.1 1/ft**  
 Floor area: **29619.7 ft<sup>2</sup>**

### PASSIVEHOUSE REQUIREMENTS

Certificate criteria: **Default Standard**

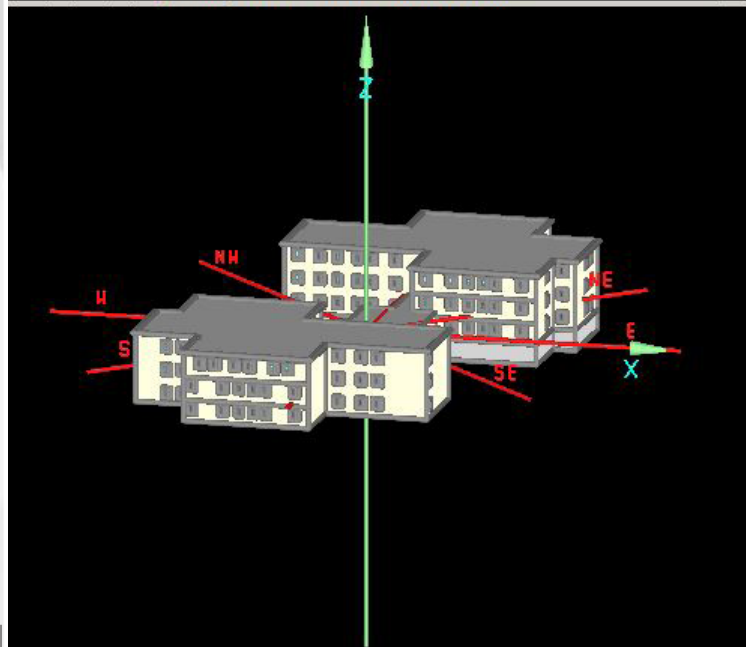

Data state/results [show warnings](#)

